

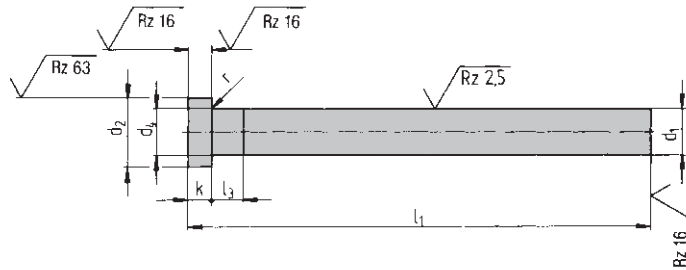

Auswerferstifte mit zylindrischem Kopf

nach DIN 1530 Teil 1, Form AH, gehärtet
ähnlich ISO 6751



Ausführung: Zylindrischer Kopf warm angestaucht, Schaft gehärtet, angelassen und feinstgeschliffen auf g 6.

Besonders geeignet für Preß- und Spritzgießwerkzeuge.

Werkstoff: WS = Legierter Kaltarbeitsstahl
1.2210, 1.2067 oder ähnlich.

Härte: Schaft: HRC 60 ± 2
Kopf: HRC 45 ± 5

Bestellbeispiel: Für Auswerferstift Form AH mit zylindrischem Kopf, durchgehärtet, Schaftdurchmesser $d_1 = 4$ mm und Gesamtlänge $l_1 = 125$ mm:

Auswerferstift DIN 1530 A 4 × 125



Auswerferstifte mit zylindrischem Kopf

nach DIN 1530 Teil 1, Form AH, gehärtet
ähnlich ISO 6751

d ₁ g 6	d ₂ 0 -0,2	d ₄ ca.	k 0 -0,05	r +0,2 0	l ₁ +2 0										l ₃ ca.						
					40	63	80	100	125	160	200	250	315	400							
1,5	3	d ₁ + 0,03	1,5	0,2			●	●	●	●	●	●			5						
1,6							●	●	●	●	●	●									
2,0	4		2		●	●	●	●	●	●	●	●									
2,2							●	●	●	●	●	●									
2,5	5		2				●	●	●	●	●	●	●								
2,7							●	●	●	●	●	●									
3,0	6		d ₁ + 0,03		3	0,3	●	●	●	●	●	●	●	●		●	●	6			
3,2									●	●	●	●	●	●		●	●				
3,5	7								●	●	●	●	●	●		●					
3,7								●	●	●	●	●	●	●							
4,0	8	d ₁ + 0,03		3	0,3		●	●	●	●	●	●	●	●	●	●	8				
4,2									●	●	●	●	●	●	●	●					
4,5									●	●	●	●	●	●	●	●					
4,7									●	●	●	●	●	●	●	●					
5,0	10			d ₁ + 0,03			3	0,3	●	●	●	●	●	●	●	●			●	●	10
5,2											●	●	●	●	●	●			●	●	
5,5	12		d ₁ + 0,03			5	0,5				●	●	●	●	●	●		●	●	12	
6,0									●	●	●	●	●	●	●	●		●	●		
6,2											●	●	●	●	●	●		●	●		
6,5											●	●	●	●	●	●		●	●		
7,0	14	d ₁ + 0,03			5	0,5					●	●	●	●	●	●	●	●	14		
8,0									●	●	●	●	●	●	●	●	●	●			
8,2									●	●	●	●	●	●	●	●					
8,5									●	●	●	●	●	●	●	●					
9,0	16			d ₁ + 0,03	5			0,5			●	●	●	●	●	●	●	●			16
10,0											●	●	●	●	●	●	●	●			
10,2									●	●	●	●	●	●	●	●					
10,5									●	●	●	●	●	●	●	●					
11,0	18		d ₁ + 0,04		7		0,8						●	●	●	●	●	●		18	
12,0											●	●	●	●	●	●	●	●			
12,2												●	●	●	●						
12,5												●	●	●	●						
14,0	22	d ₁ + 0,04			7	0,8					●	●	●	●	●	●	●	●	20		
16,0											●	●	●	●	●	●	●	●			
18,0	24			d ₁ + 0,07	8			1,0					●	●	●	●	●	●			
20,0													●	●	●	●	●	●			

● = ab Lager lieferbar. Übrige Abmessungen auf Anfrage.