

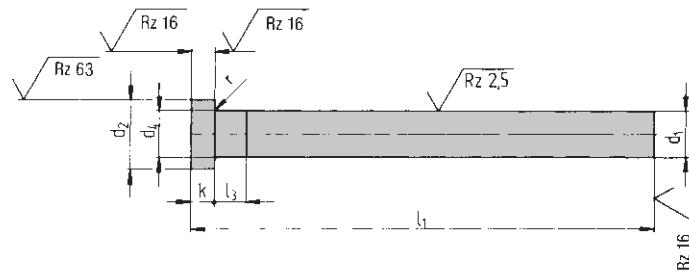

Auswerferstifte/Kernstifte unnitriert ähnlich DIN 1530 Teil 1, Form A



Ausführung: Zylindrischer Kopf warm angestaucht,
Schaft geschliffen

Härte: Schaft: Kernzugfestigkeit ca. 1400 N/mm²
Kopf: HRC 45 ± 5

**Anwendungs-
hinweis:** Nenndurchmesser d_1 ist für die
nachträgliche Nitrierung um 5 µm kleiner

Bestellbeispiel: Für unnitrierten Auswerferstift/Kernstift Form A
mit zylindrischem Kopf, Schaftdurch-
messer $d_1 = 10$ mm und Gesamt-
länge $l_1 = 160$ mm:

Werkstoff: Warmarbeitsstahl 1.2343, 1.2344 oder
ähnliche.
Anlassbeständigkeit min. 600°C.

Auswerferstift/Kernstifte DIN 1530 A 10 × 160



Auswerferstifte/Kernstifte unnitriert

ähnlich DIN 1530 Teil 1, Form A

d ₁ g 6 -0,005	d ₂ 0 -0,2	d ₄ ca.	k 0 -0,05	r +0,2 0	l ₁ +2 0											l ₃ ca.	
					100	125	160	200	250	315	400	500	630	800	1000		
1,5	3	d ₁ + 0,03	1,5	0,2	●	●	●	●								5	
2,0	4		2	0,2	●	●	●	●	●								
2,2	4		2	0,2	●	●	●	●									
2,5	5		2	0,3	●	●	●	●	●	●							
2,7	5		2	0,3	●	●	●	●	●	●							
3,0	6		3	0,3	●	●	●	●	●	●	●	●	●				
3,2					●	●	●	●	●	●	●	●					
3,5	7		3	0,3	●	●	●	●	●	●	●	●					
3,7					●	●	●	●	●	●	●						
4,0	8		3	0,3	●	●	●	●	●	●	●	●	●				
4,2					●	●	●	●	●	●	●						
4,5					●	●	●	●	●	●	●						
5,0	10		3	0,3	●	●	●	●	●	●	●	●	●	●			
5,2					●	●	●	●	●	●	●	●	●				
5,5					●	●	●	●	●	●	●	●	●				
6,0	12	5	0,5	●	●	●	●	●	●	●	●	●	●				
6,2				●	●	●	●	●	●	●	●						
6,5				●	●	●	●	●	●	●	●						
7,0	14	5	0,5	●	●	●	●	●	●	●	●	●	●				
8,0				●	●	●	●	●	●	●	●	●	●	●	●		
8,2				●	●	●	●	●	●	●	●	●	●				
8,5				●	●	●	●	●	●	●	●	●	●				
9,0	16	5	0,5	●	●	●	●	●	●	●	●	●	●	●			
10,0				●	●	●	●	●	●	●	●	●	●	●	●		
10,2				●	●	●	●	●	●	●	●	●	●				
10,5	18	7	0,8	●	●	●	●	●	●	●	●	●	●	●			
11,0				●	●	●	●	●	●	●	●	●					
12,0				●	●	●	●	●	●	●	●	●	●	●	●		
12,2	22	7	0,8	●	●	●	●	●	●	●	●	●	●	●			
12,5				●	●	●	●	●	●	●	●	●	●	●			
14,0	24	7	0,8	●	●	●	●	●	●	●	●	●	●	●			
16,0				●	●	●	●	●	●	●	●	●	●	●	●		
18,0	26	d ₁ + 0,07	7	0,8	●	●	●	●	●	●	●	●	●	●	18		
20,0	26	d ₁ + 0,07	8	1,0		●	●	●	●	●	●	●	●	●	20		
25,0	32	d ₁ + 0,1	10	1,0			●	●	●	●	●	●	●	●	25		
32,0	40		10	1,0				●	●	●	●	●	●	●	●	32	

● = ab Lager lieferbar. Übrige Abmessungen auf Anfrage.